

Approved Mini Storage Project
4880 Broad St.
San Luis Obispo, CA



For Sale

Contact:
Steve McCarty
DRE# 00977930

Steve Davis
DRE# 01843738



Property Features:

- ◆ Highly visible location; >900 +/- LF of frontage on Broad St./Highway 227
- ◆ 5.7 acres
- ◆ Over 116,000 sq ft. of proposed mini storage space
- ◆ 6 proposed buildings with units ranging from 5'x5' to 10'x29'
- ◆ Easy access location: across the street from the San Luis Obispo Airport on Broad St./Highway 227
- ◆ Sale Price: \$2,543,900

Stafford-McCarty Commercial
Real Estate
641 Higuera St., Suite 201
San Luis Obispo, CA 93401
805-543-1801
www.staffordmccarty.com



Summary

4880 Broad St. is an entitled mini-storage project across from the San Luis Obispo Airport. With over 116,000 sq. ft. of proposed storage unit space, this project provides significant density in a key location.

"A great opportunity to purchase an entitled mini-storage facility."

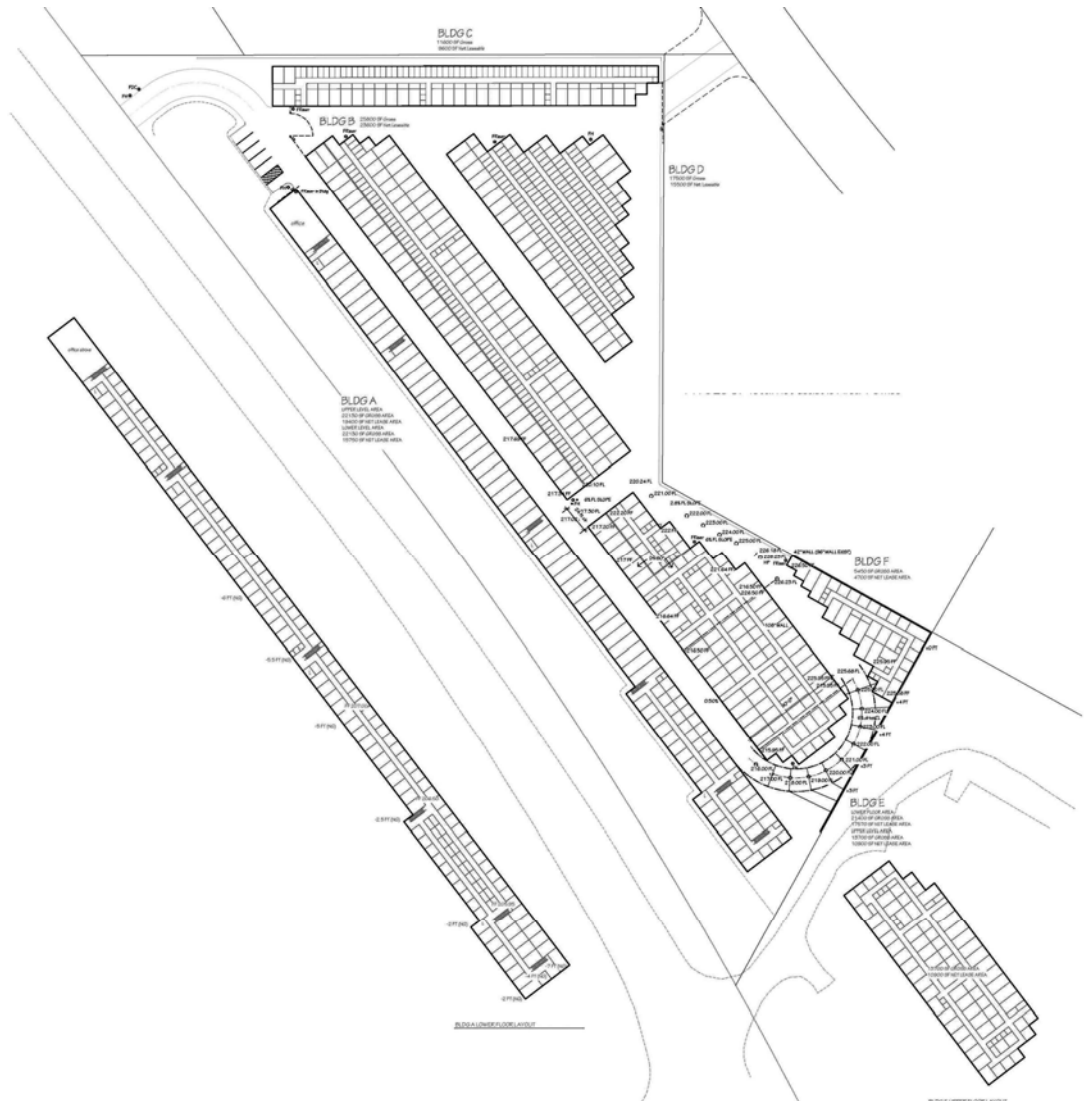

Proposed Building Layout

Stafford-McCarty Commercial Real Estate

641 Higuera Street, Suite 201, San Luis Obispo, CA 93401 * 805-543-1801 (voice) * 805-543-1857 (fax)
www.staffordmccarty.com

Information contained herein has been obtained from the owner of the property or from other sources deemed reliable. We have no reason to doubt its accuracy, but we do not guarantee it.

Property Characteristics

Property Description:	Six Proposed Free-Standing Buildings.
Land Use Zone:	Industrial
Overall Parcel Size:	5.70 Acres

Proposed Building Sizes

	Gross	Net Leaseable
Building A: Upstairs	22,130	19,400
Building A: Downstairs	22,130	15,750
Building B	25,800	23,600
Building C	11,600	9,600
Building D	17,500	15,500
Building E: Upstairs	21,400	17,570
Building E: Downstairs	13,700	10,800
Building F	5,450	4,700
Total	139,710	116,920

Breakdown of Proposed Storage Unit Sizes

Unit Size	Bldg A Up	Bldg A Down	Bldg B	Bldg C	Bldg D	Bldg E Up	Bldg E Down	Bldg F	Total
5x5	2	6	6	12	0	13	22	10	71
5x7	2	0	0	0	0	0	0	0	2
5x9	2	0	0	0	0	0	0	0	2
5x10	0	26	78	89	168	7	5	2	375
9x10	1	0	0	0	0	0	0	0	1
10x10	23	56	2	2	16	27	36	14	176
10x15	26	58	0	31	0	34	36	6	191
10x20	3	0	72	0	23	12	39	9	158
10x25	0	0	0	0	4	0	0	1	5
10x29	43	0	0	0	0	0	0	0	43

Stafford-McCarty Commercial Real Estate

641 Higuera Street, Suite 201, San Luis Obispo, CA 93401 * 805-543-1801 (voice) * 805-543-1857 (fax)
www.staffordmccarty.com

Information contained herein has been obtained from the owner of the property or from other sources deemed reliable. We have no reason to doubt its accuracy, but we do not guarantee it.

Facility Competition Survey Map

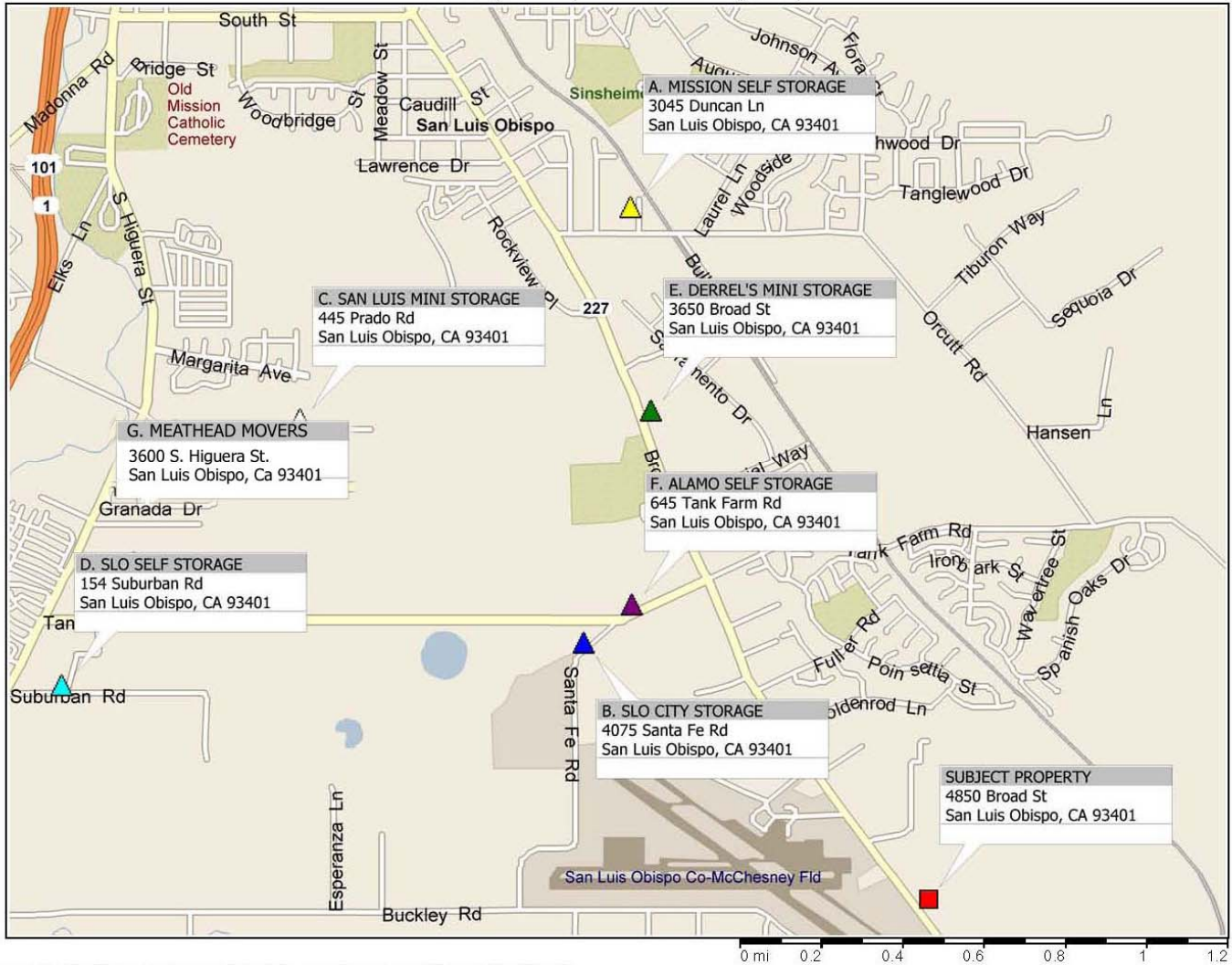

Stafford-McCarty Commercial Real Estate

641 Higuera Street, Suite 201, San Luis Obispo, CA 93401 * 805-543-1801 (voice) * 805-543-1857 (fax)
www.staffordmccarty.com

Information contained herein has been obtained from the owner of the property or from other sources deemed reliable. We have no reason to doubt its accuracy, but we do not guarantee it.

4880 Broad St., San Luis Obispo, CA



Stafford-McCarty Commercial Real Estate

641 Higuera Street, Suite 201, San Luis Obispo, CA 93401 * 805-543-1801 (voice) * 805-543-1857 (fax)
www.staffordmccarty.com

Information contained herein has been obtained from the owner of the property or from other sources deemed reliable. We have no reason to doubt its accuracy, but we do not guarantee it.